

Datasheet

LED Tri-proof Light

B Version



• Product Features

- > 1-10V dimming with flicker free driver
- > Compatible Dimmer : Lutron / LEVITON
- > Single or Double wiring
- > IP 65 /IK10 Approval
- > Multiple Link with double wiring
- > Patent aluminum case as heatsink
- > 5 years warranty

• Options

- > Single or Double wiring
- > Color Index: Ra>80 or Ra>90
- > Dimming : 1-10V dimming or ON-OFF or DALI
- > Lumen Efficacy : 100LM/W , 125LM/W ,140LM/W

• Application

- > Replacement for fluorescent NCF ,
- > Warehouses , Factories, Car parks , Sports facilities,
- > Sports facilities, Outdoor & Indoor Locations.

• Dimension

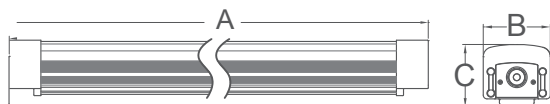

Product Name	A	B	C
2ft/60cm	625	85	78
4ft/120cm	1225	85	78
5ft/150cm	1525	85	78
8ft/240cm	2425	85	78

Unit:mm

• Product Picture



• Explosion drawing

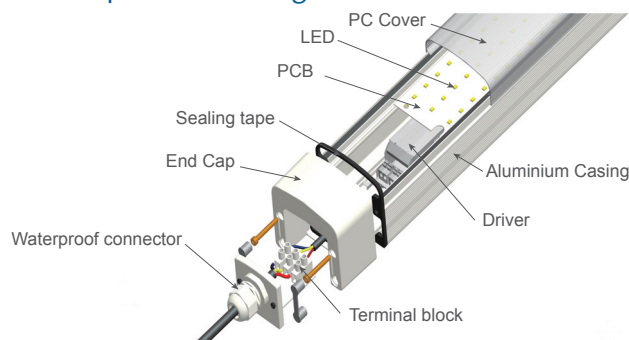

• Product code policy

TR XX -XX X XX - X X X X X- XXX

01 02 03 04 05 06 07 08 09 10 11

01. Product category: TR: Tri-proof Light
02. Product dimension: eg: 04:4ft/120CM; 06:6ft/180cm
03. Rated power: eg: 40: 40W; 1A:100W
04. Luminous Efficacy: S: Standard 100LM/W;P:Premium 125LM/W
05. Color Temperature: eg:N1: 4000~4500K, TR:Tri-color
06. Product version: B: B version tri-proof light
07. Structural function: F:Frosted cover
08. Electrical function:V:1-10V dimming
- 09.Power attribute:1:AC200-240V Flicker free power drive
- 10.Power supply manufacturer
- 11.Series No.: 001-499.

• Photometry Curve

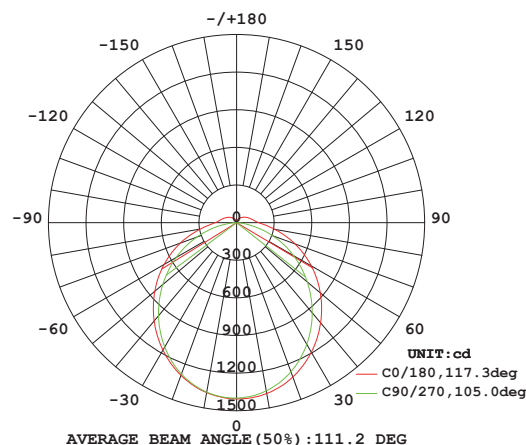

• Technical / Electrical Characters (at TA=25°C)

Item	Symbol	L=600/2ft			L=1200/4ft			L=1200/4ft			L=1500/5ft			L=2400/8ft			
		Standard	Premium	Deluxe	Standard	Premium	Deluxe	Standard	Premium	Deluxe	Standard	Premium	Deluxe	Standard	Premium	Deluxe	
Rated Power	W	22W	22W	22W	40W	40W	40W	60W	60W	60W	60W	60W	60W	100W	100W	100W	
Lumen Efficacy	Lm/w	100	125	140	100	125	140	100	125	140	100	125	140	100	125	140	
Product Code	/	TR02-22SN1-BFN1B-001	TR02-22PN1-BFN1B-001	TR02-22DN1-BFN1B-001	TR04-40SN1-BFN1B-001	TR04-40PN1-BFN1B-001	TR04-40DN1-BFN1B-001	TR04-60SN1-BFN1B-001	TR04-60PN1-BFN1B-001	TR04-60DN1-BFN1B-001	TR05-60SN1-BFN1B-001	TR05-60PN1-BFN1B-001	TR05-60DN1-BFN1B-001	TR06-1ASN1-BFN1B-001	TR06-1APN1-BFN1B-001	TR06-1ADN1-BFN1B-001	
LED Type /Qty	SMD2835	143pcs	143pcs	143pcs	234pcs	234pcs	234pcs	325pcs	325pcs	325pcs	325pcs	325pcs	325pcs	520pcs	520pcs	520pcs	
Lumen Efficacy	Lm/w	typ.100	typ.125	typ.140	typ.100	typ.125	typ.140	typ.100	typ.125	typ.140	typ.100	typ.125	typ.140	typ.100	typ.125	typ.140	
Luminous Flux	Frosted	typ. 2200	typ. 2750	typ. 3050	typ. 4000	typ. 5000	typ. 5600	typ. 6000	typ. 7500	typ. 8400	typ. 6000	typ. 7500	typ. 8400	typ. 10000	typ. 12500	typ. 14000	
Color Index	CRI (Ra)	Ra>80 OR Ra >90															
Power Factor	PF	PF>0.95															
Color Temperature	TC (K)	WW: 3000K			NW: 4000K			PW: 5000K			CW: 6000K						
Beam Angle	Degree	120 degree															
LED current	mA	Constant 50mA															
Input Voltage	V	AC200-240V/50Hz															
Working Voltage	V	Constant DC36-42V															
Housing material	/	Aluminum +PC															
Protection Class	IP	IP65/ IK10															
Temperature	°C	Operation : -15°C~+50°C							Storage: -25°C~+55°C								
Life Span	h	50,000 hours															
Warranty	/	5 years															

• DLC Technical Specification

Item	Symbol	Specification / Data		
Color Index	CRI	Ra>80 , R9>0		
Luminous Efficacy	Lm/W	Standard :typ.100-110LM/W	Premium :typ.120-130Lm/W	Deluxe:typ. 140-150LM/W
Energy efficiency Class	/	A+ / A++		
Color consistency in level	/	Max. 6SDCM		
THD	%	<15%		
Starting Time	S	<0.5S		
Switching Cycle before Failure	/	>100,000 times		
Premature failure rate @1000h	/	0		
Lumen Maintenance @ 6000h	%	>80%		



• Wiring Method

1. Single Side AC Input



2. Double Side AC Input and Multiple Link

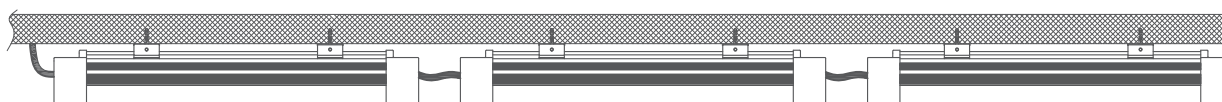

• Installation Instructions

1. Surface mounting procedure:

1). Fix the supplied metal clips onto a mounting surface as per the installation below

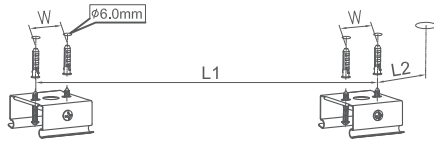

Product Size	Size W	Size L1	Size L2
625*85*78mm	22mm	300mm	170mm
1225*85*78mm	22mm	600mm	240mm
1525*85*78mm	22mm	750mm	360mm
1825*85*78mm	22mm	1200mm	360mm
2425*85*78mm	22mm	1700mm	3600mm

2). Push the Lamp body into the mounting clips

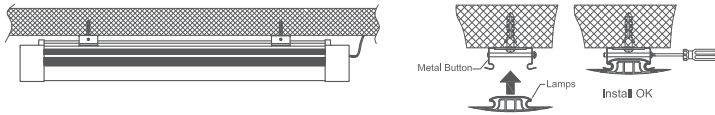

3). Open the lamp and take out the Junction board by the screwdriver, connect the L/N/⊕ wire in the Junction board accordingly; fix the Junction board by the screwdriver

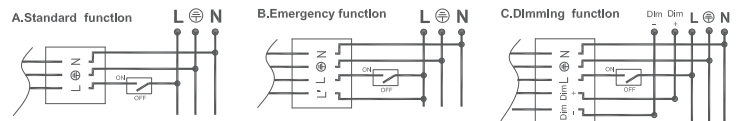
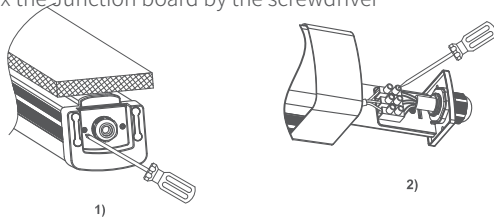

2. Suspending Procedure:

1). Install the suspension rope then wiring as below instructions

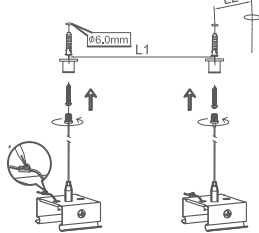

2). Adjust the length of the suspension rope to reach the suitable height and push the Lamp body into the mounting clips

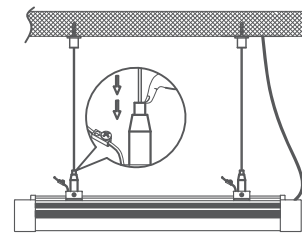

3). Open the lamp and take out the Junction board by the screwdriver, connect the L/N/⊕ wire in the Junction board accordingly; fix the Junction board by the screwdriver

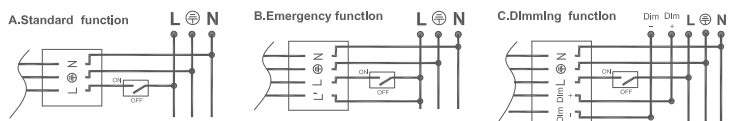
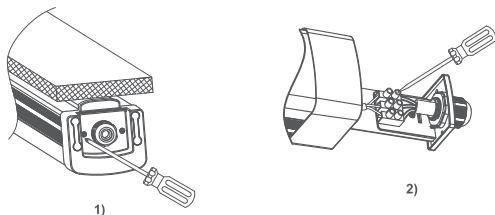

• Package

Product Type	Rated Power	Inner Box	Outer Carton	Qty/Carton	Unit N.W	G.W/Carton
60cm/2ft	22W	700 x 92 x 82mm	720 x 190 x 215mm	4Pcs	1335g	7.8Kg
120cm/4ft	40W/60W	1300 x 92 x 82mm	1320 x 190 x 215mm	4Pcs	2355g	12.5Kg
150cm/5ft	60W	1600 x 92 x 82mm	1620 x 190 x 215mm	4Pcs	3100g	15.5Kg
240cm/8ft	100W	2500 x 92 x 82mm	2520 x 190 x 215mm	4Pcs	4600g	24.0Kg

! CAUTION

- ✘ In case of electric shock, please make sure the power is off before installation.
- ✘ The lamp should be installed and operated by a qualified electrician or technician in accordance with relevant local codes.
- ✘ Do not use sharp tools near or on the surface of the lamp.
- ✘ Unpack and examine the product carefully. Report any damage and save all packing materials if any portion of the product was damaged during transportation.